

# 480SS Series Stainless Steel Frost-Proof Wall Hydrants



## Stainless Steel Frost-Proof Wall Hydrants with a factory installed self-draining vacuum breaker

### Features & Benefits

- 316 Marine & Food-grade stainless steel
- Certified to NSF/ANSI 372; UPC listed
- Factory installed vacuum breaker that provides protection against backflow and relieves back pressure
- Arrowhead green oval handle
- Wall flange with built-in offset to allow water drainage upon shut-off
- Superior corrosion resistance- does not corrode in humid or extreme weather environments
- Maximum pressure: 125 PSI
- Maximum temperature: 140° F
- Arrowhead 3-year limited warranty
- Available in 2, 4, 6, 8, 10, 12 & 14 inch lengths





## Base Model & Options

482SS Series- 1/2" PEX Inlet	486SS Series- 1/2" MIP & Sweat Inlets	489SS Series- 1/2" PEX Inlet
# 482-xxSS 1/2" PEX (ASTM 1960) Inlet	# 486-xxSS 1/2" Copper Sweat ID   1/2" MIP OD Inlet	# 489-xxSS 1/2" Crimp PEX (ASTM F1807) Inlet

## Repair & Replacement Parts

<b>Stem Rebuild Kit</b>  <b># PK1000</b> Includes seat washer (1), seat washer screw (1), nylon bonnet washer (1), & handle (1) screw	<b>Replacement Oval Handle &amp; Screw</b>  <b># PK1290</b> Replacement green oval handle (die-cast aluminum) & stainless steel self-tapping screw
<b>Self-Draining Vacuum Breaker</b>  <b># PK1390</b> Replacement self-draining vacuum breaker, chrome-plated - 1-1/16" Fine thread inlet	<b>Complete Stem Assembly</b>  <b># PK80xx *</b> 04, 06, 08, 10, 12, 14 - inch stem assembly (see below for total stem length)

- PK8004 = 8"
- PK8006 = 10"
- PK8008 = 12"
- PK8010 = 14"
- PK8012 = 16"
- PK8014 = 18"

**WARNING:** Frost-Proof wall hydrants must be installed with a downward tilt toward the hose thread outlet AND the hose or other devices must be removed in cold and freezing weather. Failure to properly winterize a frost-proof wall hydrant can result in damage caused by freezing water and is not covered under warranty. For more information please visit our website at [www.arrowheadbrass.com](http://www.arrowheadbrass.com)

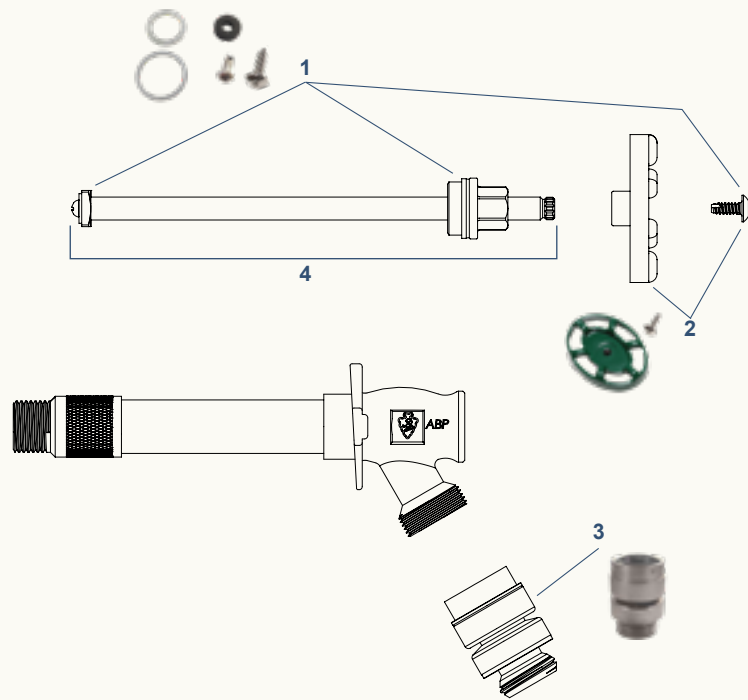

Job Name: _____	Page No: _____
Section No: _____	Contractor: _____
Schedule No: _____	
Purchase Order No: _____	



**WARNING:** This product can expose you to chemicals including lead, which is known to the State of California to cause, cancer and reproductive harm. For more information, go to [www.P65Warnings.ca.gov](http://www.P65Warnings.ca.gov)