



**221CCLF**



**248LF**



**250LF**



**249LF**



**247LF**

## Washing Machine Valves

### Features & Benefits

- Heavy-duty, nickel-plated lead-free brass construction
  - NSF/ANSI 372 certified by IAPMO
  - Utilizes Arrowhead's exclusive no-leak one-piece bonnet with EPDM O-ring seal
  - Models 248LF and 250LF features 3/4" male hose thread bypass allowing in-line installation for hose thread hookup
  - Model 248LF includes reversible plug and 3/4" male hose thread adapter
  - Maximum pressure: 125 PSI
  - Maximum temperature: 140° F
  - Flow rate: 11 GPM at 50 PSI
  - **3-year limited warranty**
- Available in:
    - 1/2" copper compression inlet x 3/4" MHT outlet (**221CCLF**)
    - 1/2" FIP inlet x 3/4" MHT outlet (**247LF**)
    - 1/2" FIP inlet x 1/2" MIP outlet with reversible 3/4" MHT bypass (**248LF**)
    - 1/2" FIP thread inlet x 3/4" MHT outlet (**249LF**)
    - 1/2" FIP thread inlet x 1/2" MIP outlet with 3/4" MHT bypass (**250LF**)





## Materials & Dimensions

Component	Material
Valve Body	Lead-Free Brass*
Stem	Lead-Free Brass*
Bonnet	Lead-Free Brass*
Hose Adapter	Lead-Free Brass*
Bypass Plug	Lead-Free Brass*
O-ring	EPDM
Seat Washer	SBR
Seat Screw	Stainless Steel
Bonnet Washer	Nylon
Handle	Aluminum
Handle Screw	Stainless Steel
Nut & Ferrule	Brass

\* Lead Free is defined as less than 0.25% lead content, certified by IAPMO to NSF/ANSI 372

## Repair & Replacement Parts

### Replacement Burnished Tee-Handle

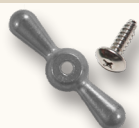

#### #PK1260

Replacement burnished tee-handle & stainless steel self-tapping screw

### Replacement O-ring Style Stem Assembly



#### #PK1110

Replacement O-ring style nickel-plated stem assembly

### Replacement Brass Compression Nut & Ferrule

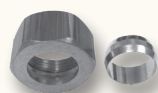

#### #PK1170

Replacement brass compression nut & ferrule (nickel-plated)

### Replacement Bypass Hose Adapter



#### #PK1200

Replacement bypass hose adapter, plug, & gaskets (2) for 248LF

### Add-on hose Vacuum Breaker



#### #58ABPCHR

Add-on hose vacuum breaker with set screw - chrome finish

### Replacement Loose-Key Lock-Shield



#### #PK1155

Replacement loose-key lock-shield for Arrowhead hose bibs & sillcocks. Nickel-plated

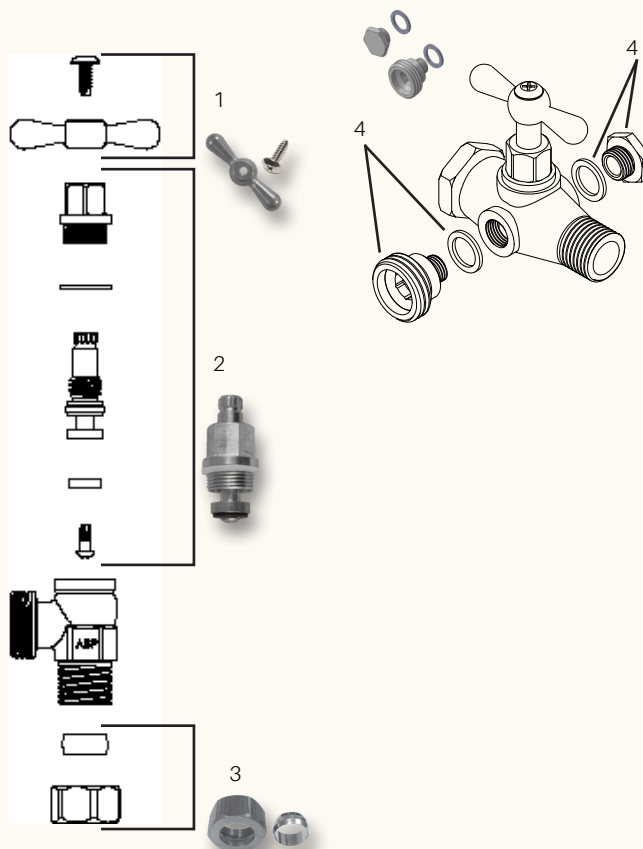

**WARNING:** This product can expose you to chemicals including lead, which is known to the State of California to cause, cancer and reproductive harm. For more information, go to [www.P65Warnings.ca.gov](http://www.P65Warnings.ca.gov)