

255LF - 355LF
Sillcocks



Sillcocks

Features & Benefits

- Heavy-duty lead-free brass construction
 - NSF/ANSI 372 certified by IAPMO
 - Utilizes Arrowhead's exclusive no-leak one-piece bonnet with EPDM O-ring seal
 - Integrated brass flange with enclosed screw holes
 - Model 248LF includes reversible plug and 3/4" male hose thread adapter
 - Maximum pressure: 125 PSI
 - Maximum temperature: 140° F
 - Flow rate: 8-9 GPM at 50 PSI
 - **3-year limited warranty**
- Available in:
 - 1/2" FIP thread x 3/4" MHT (**225LF**)
 - 3/4" FIP thread x 3/4" MHT (**355LF**)
 - 1/2" PEX (ASTM F1807) x 3/4" MHT (**255PEXLF**)
 - 1/2" Copper sweat x 3/4" MHT (**255SWLF**)
 - 3/4" Copper sweat x 3/4" MHT (**355SWLF**)
 - Factory installed anti-siphon vacuum breaker (**255BFPLF / 355BFPLF**)
 - Factory installed anti-siphon vacuum breaker (**255LKLF / 355LKLF**)





255LF - 355LF Series
Sillcocks

Materials & Dimensions

Component	Material
Valve Body	Lead Free Brass*
Stem	Lead Free Brass*
Bonnet	Lead Free Brass*
O-ring	EPDM
Seat Washer	SBR
Seat Screw	Stainless Steel
Bonnet Washer	Nylon
Handle	Aluminum
Handle Screw	Stainless Steel
PEX Adapter	Lead Free Brass*

* Lead Free is defined as less than 0.25% lead content, certified by IAPMO to NSF/ANSI 372

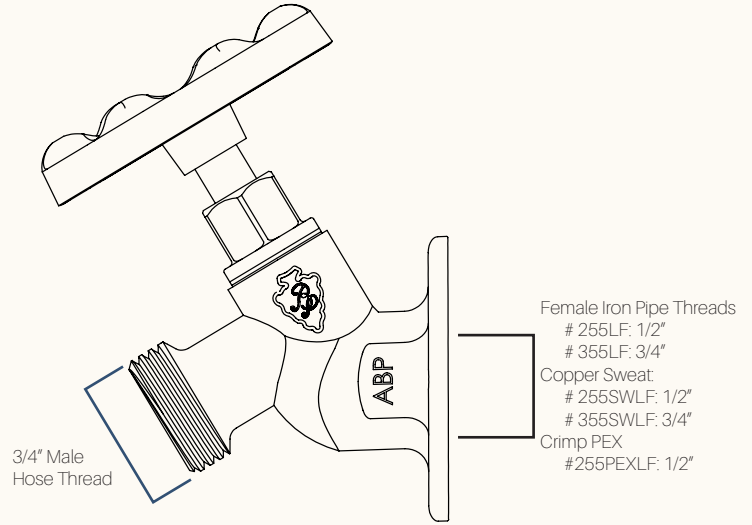

Repair & Replacement Parts

<p>Replacement Green Oval Handle</p>  <p>#PK1290 Replacement Arrowhead green oval handle & stainless steel self-tapping screw</p>	<p>Replacement O-ring Style Stem Assembly</p>  <p>#PK1100 Replacement O-ring style stem assembly for hose bibs & sillcocks</p>
<p>Replacement Brass Compression Nut & Ferrule</p>  <p>#PK1000 Stem rebuild kit: seat washer, seat washer screw, nylon bonnet washer, & handle screw</p>	<p>Fine-Thread Vacuum Breaker</p>  <p>#PK1360 Replacement fine-thread vacuum breaker (brass finish)</p>
<p>Replacement Loose-Key Lock-Shield</p>  <p>#PK1150 Replacement Loose-Key Lock-Shield for Arrowhead hose bibs & sillcocks</p>	<p>Replacement Green Wheel Handle</p>  <p>#PK1250 Replacement green wheel & stainless steel self-tapping screw</p>

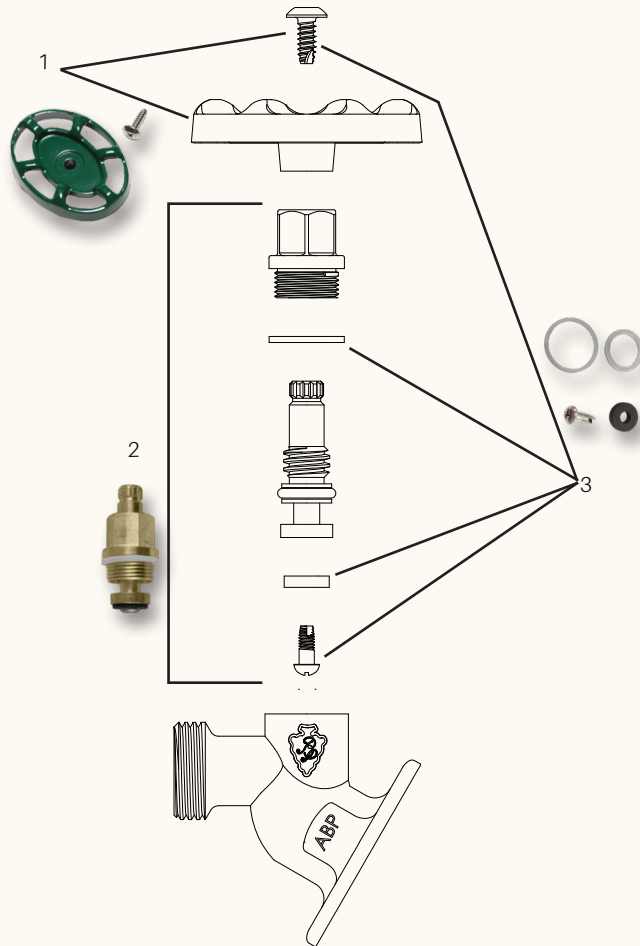

WARNING: This product can expose you to chemicals including lead, which is known to the State of California to cause, cancer and reproductive harm. For more information, go to www.P65Warnings.ca.gov