



450 Series Lead Free Standard Frost-Proof Wall Hydrants

Arrowhead Brass 450 series Lead Free Standard Frost-Proof Wall Hydrants are made of heavy-duty Lead Free brass and copper. The 450 series Frost-Proof Wall Hydrant provides protection against freezing pipes by extending the water supply into heated wall space. Available in various lengths and inlet connections, Arrowhead Brass frost-proof wall hydrants are perfect for any installation to provide outdoor watering all year. Arrowhead Brass 450 series are certified to NSF/ANSI 372 Lead-Free by IAPMO.



Models

451-**LF	3/4" Cold Expansion PEX (ASTM F1960)	
452-**LF	1/2" Cold Expansion PEX (ASTM F1960)	
455-**LF	1/2" Female Pipe Thread ID. 3/4" Male Pipe Thread OD.	
456-**LF	1/2" Copper Sweat ID. 1/2" Male Pipe Thread OD.	
457-**LF	3/4" Crimp PEX (ASTM F1807)	
458-**LF	3/4" Copper Sweat ID. 3/4" Male Pipe Thread OD.	
459-**LF	1/2" Crimp PEX (ASTM F1807)	

**** = Hydrant length:**

- 02 - 2" insertion depth
- 04 - 4" insertion depth
- 06 - 6" insertion depth
- 08 - 8" insertion depth
- 10 - 10" insertion depth
- 12 - 12" insertion depth
- 14 - 14" insertion depth

Longer lengths available by special order

Features and Specifications

- Heavy duty lead free brass and copper construction. NSF/ANSI 372 certified Lead Free by IAPMO.
- Utilizes Arrowhead's exclusive no-leak one-piece bonnet with EPDM O-ring seal.
- Nickel plated, solid brass body and wall flange with built-in offset to allow water drainage upon shut-off.
- Maximum pressure: 125 PSI. Max temperature: 140° F
- Flow rate: 13 GPM at 50 PSI.
- 3-year limited warranty.
- Rubber-coated oval handle, or available in loose-key lock-shield (LKLF) models for tamper-proof operation.

Prevent unwanted water use with Loose Key Models: "LKLF" Suffix





450 Series Lead Free Standard Frost-Proof Wall Hydrants

Dimensions

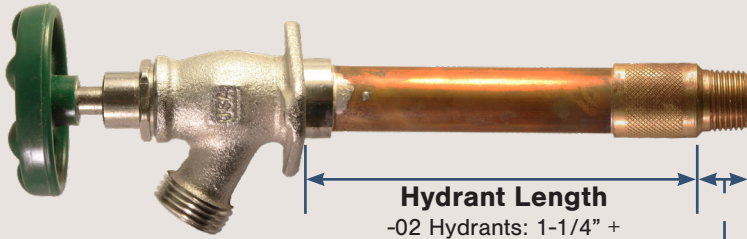

Hydrant Length
 -02 Hydrants: 1-1/4" +
 -04 Hydrants: 4" +
 -06 Hydrants: 6" +
 -08 Hydrants: 8" +
 -10 Hydrants: 10" +
 -12 Hydrants: 12" +
 -14 Hydrants: 14" +

Inlet #	Connection Type	Add. Length
1	3/4" Cold Expansion PEX (ASTM F1960)	2"
2	1/2" Cold Expansion PEX (ASTM F1960)	1-3/4"
5	1/2" Female Pipe Thread ID. 3/4" Male Pip Thread OD.	1-5/8"
6	1/2" Copper Sweat ID. 1/2" Male Pipe Thread OD.	1-1/2"
7	3/4" Crimp PEX (ASTM F1807)	1-5/8"
8	3/4" Copper Sweat ID. 3/4" Male Pipe Thread OD.	1-5/8"
9	1/2" Crimp PEX (ASTM F1807)	1-5/8"

Part Kits

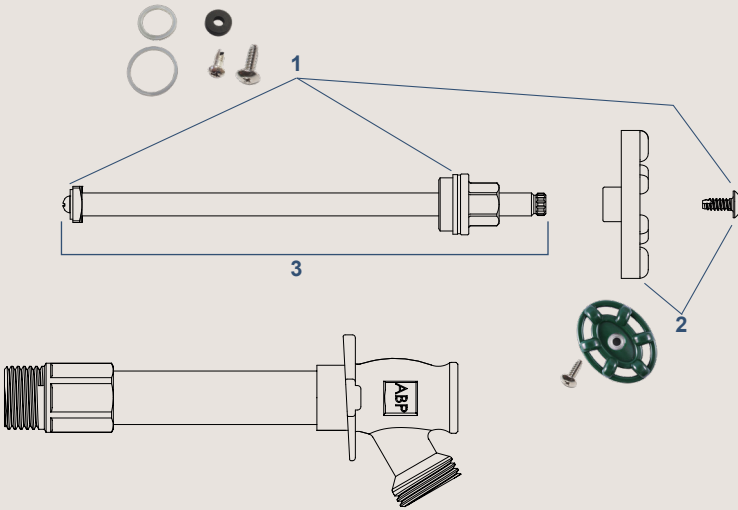

ID	Part #	Description
1	PK1000	Stem Rebuild Kit: Seat washer, seat washer screw, nylon bonnet washer & handle screw
2	PK1295	Rubber-Coated Oval Handle (Die-cast Aluminum) and Stainless Steel Self-Tapping Handle Screw
3	(See below)	Replacement Stem Assembly

Replacement Stem Assemblies



Total Stem Length (Overall)

Part #	Description	Length
PK8002	Stem assembly for 2" 450/480 series hydrant	6" total
PK8004	Stem assembly for 4" 450/480 series hydrant	8" total
PK8006	Stem assembly for 6" 450/480 series hydrant	10" total
PK8008	Stem assembly for 8" 450/480 series hydrant	12" total
PK8010	Stem assembly for 10" 450/480 series hydrant	14" total
PK8012	Stem assembly for 12" 450/480 series hydrant	16" total
PK8014	Stem assembly for 14" 450/480 series hydrant	18" total

*For Frost-Proof Hydrants installed before 1999, the total stem length will be 1/4" longer than the above stated lengths. For compatible stems, include the suffix "SP" in part number (i.e. PK8006SP = total length 10-1/4")

Warning: Frost-Proof Wall Hydrants must be installed with a downward tilt toward hose thread outlet AND the hose or other devices must be removed in cold and freezing weather. Failure to properly winterize a frost-proof wall hydrant can result in damage caused by freezing water and is not covered by under warranty.