

255XLF - 355XLF Extra-Large Flange Sillcocks



Extra-Large Flange Sillcocks

Features & Benefits

- Heavy-duty lead-free brass construction
- NSF/ANSI 372 certified by IAPMO
- Utilizes Arrowhead's exclusive no-leak one-piece bonnet with EPDM O-ring seal
- Oversized integrated 3-1/4" brass flange designed for extra wall coverage
- 2-3/4" wide enclosed screw holes to securely fasten to the mounting wall
- Maximum pressure: 125 PSI
- Maximum temperature: 140° F
- Flow rate: 9 GPM at 50 PSI
- **3-year limited warranty**
- Available in:
 - 1/2" FIP thread x 3/4" MHT - XL flange (**255XLF**)
 - 3/4" FIP thread x 3/4" MHT - XL flange (**355XLF**)

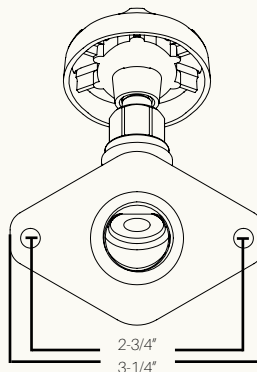



255LF - 355LF Series
Extra-Large Flange Sillcocks

Materials & Dimensions

Component	Material
Valve Body	Lead-Free Brass
Stem	Lead-Free Brass
Bonnet	Lead-Free Brass
O-ring	EPDM
Seat Washer	SBR
Seat Screw	Stainless Steel
Bonnet Washer	Nylon
Handle	Aluminum
Handle Screw	Stainless Steel

* Lead Free is defined as less than 0.25% lead content, certified by IAPMO to NSF/ANSI 372

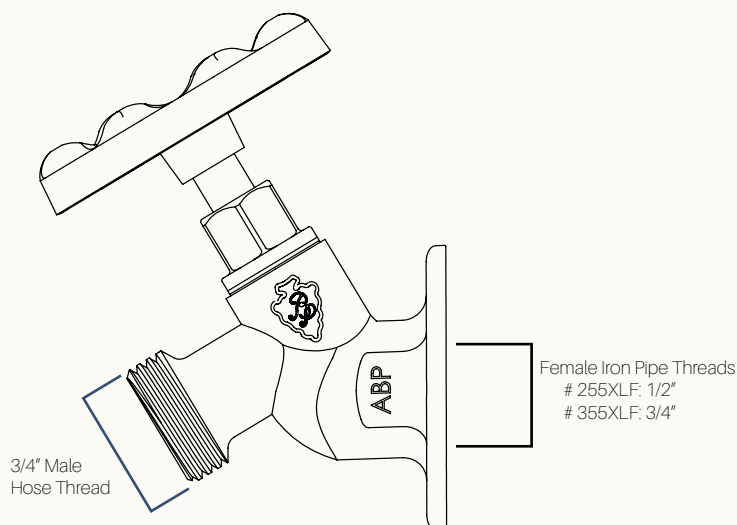

Repair & Replacement Parts

Replacement Green Tee -Handle  #PK1270 Replacement Arrowhead green oval handle & stainless steel self-tapping screw	Replacement O-ring Style Stem Assembly  #PK1100 Replacement O-ring style stem assembly for hose bibs & sillcocks
Replacement Brass Compression Nut & Ferrule  #PK1000 Stem rebuild kit: seat washer, seat washer screw, nylon bonnet washer, & handle screw	Fine-Thread Vacuum Breaker  #PK1360 Replacement fine-thread vacuum breaker (brass finish)
Replacement Loose-Key Lock-Shield  #PK1150 Replacement Loose-Key Lock-Shield for Arrowhead hose bibs & sillcocks	Replacement Green Wheel Handle  #PK1250 Replacement green wheel & stainless steel self-tapping screw

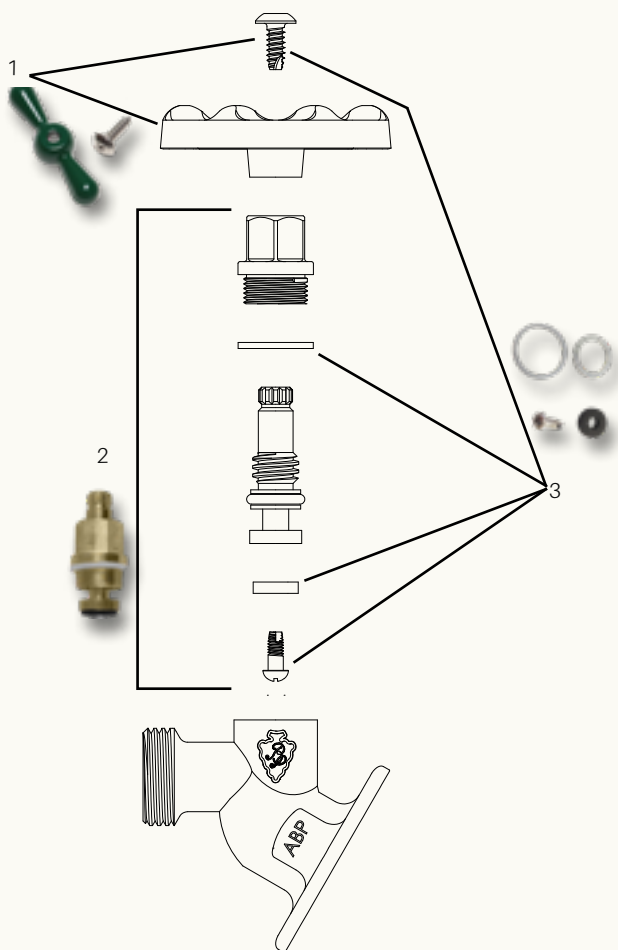

WARNING: This product can expose you to chemicals including lead, which is known to the State of California to cause, cancer and reproductive harm. For more information, go to www.P65Warnings.ca.gov