

# Lead-Free Commercial Sillcocks 28LF - 38LF Series



## Lead-Free Commercial Sillcocks

### Features & Benefits

- Heavy-duty lead-free brass construction. NSF/ANSI 372 certified Lead Free by IAPMO.
- Utilizes Arrowhead's exclusive no-leak one-piece bonnet with EPDM O-ring seal or maintenance-free, easy operation with years of service.
- Integrated brass flange with enclosed screw holes to securely fasten the sillcock to the wall or wall box.
- Includes ASSE 1011 anti-siphon vacuum breaker, tamper-resistant lock-shield bonnet with green wheel handle.
- For loose key operation to prevent unwanted water use, simply remove the green handle and use the included removable loose key to operate.
- Self-draining vacuum breaker automatically drains the sillcock upon shut off if the hose is disconnected
- Available in 1/2" (**28LF**) and 3/4" (**38LF**) copper sweat, and in rough brass, nickel-plated (**P**) or polished chrome (**C**) finishes.
- Maximum pressure: 125 PSI. Max temperature: 140° F
- Flow rate: 5-6 GPM at 50 PSI.
- 3-year limited warranty.
- ASSE 1011 certified.





Lead Free Commercial Sillcocks  
28LF - 38LF Series

## Base Model & Options

28LF	28PLF	28CLF
		
<b># 28LF</b> 1/2" Female Iron Pipe x 3/4" Male Hose Thread, Rough Brass	<b># 28PLF</b> 1/2" Female Iron Pipe x 3/4" Male Hose Thread, Nickel-Plated	<b># 28CLF</b> 1/2" Female Iron Pipe x 3/4" Male Hose Thread, Polished Chrome
38LF	38PLF	38CLF
		
<b># 38LF</b> 3/4" Female Iron Pipe x 3/4" Male Hose Thread, Rough Brass	<b># 38PLF</b> 3/4" Female Iron Pipe x 3/4" Male Hose Thread, Nickel-plated	<b># 38CLF</b> 3/4" Female Iron Pipe x 3/4" Male Hose Thread, Polished Chrome

Component	Material
Valve Body	Lead Free Brass*
Stem	Lead Free Brass*
Lock-Shield Bonnet	Lead Free Brass*
O-ring	EPDM
Seat Washer	SBR
Seat Screw	Stainless Steel
Bonnet Washer	Nylon
Handle & Key	Aluminum
Handle Screw	Stainless Steel
Vacuum Breaker	Lead Free Brass*, POM, NBR & Stainless Steel

Now available, Commercial Sillcock Wall Box: # ACSB. See below for more details.



## Repair & Replacement Parts

ID	Part #	Description
1	PK1250	Replacement Green Wheel Handle & Stainless Steel Self-Tapping Screw
2	PK1150	Replacement Lock-Shield Stem Assembly & Loose Key
2	PK1155	Replacement Lock-Shield Stem Assembly & Loose Key - Chrome Plated
3	PK1000	Stem Rebuild Kit: Seat washer, seat washer screw, nylon bonnet washer & handle screw
4	PK1300	Replacement Loose Key
5	58ABP	Replacement Vacuum Breaker
5	58ABPCHR	Replacement Vacuum Breaker - Chrome Plated
6	ACSB	Commercial Sillcock Wall Box, Nickel Plated Brass

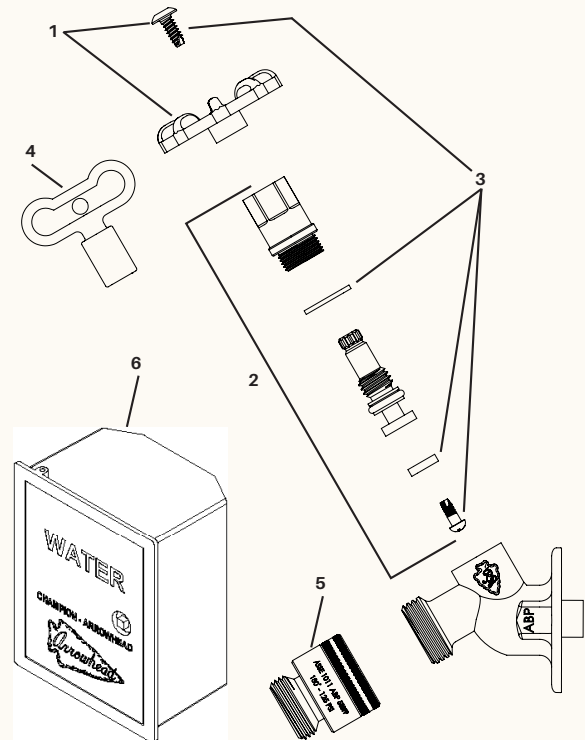

**WARNING:** This product can expose you to chemicals including lead, which is known to the State of California to cause cancer and reproductive harm. For more information, go to [www.P65Warnings.ca.gov](http://www.P65Warnings.ca.gov)