

Lead-Free Commercial Sillcocks 25SWLF - 35SWLF Series

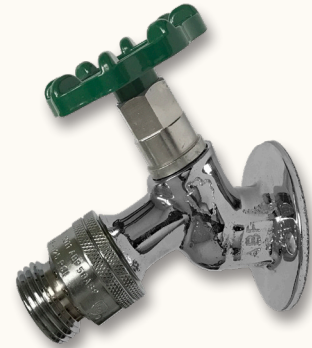
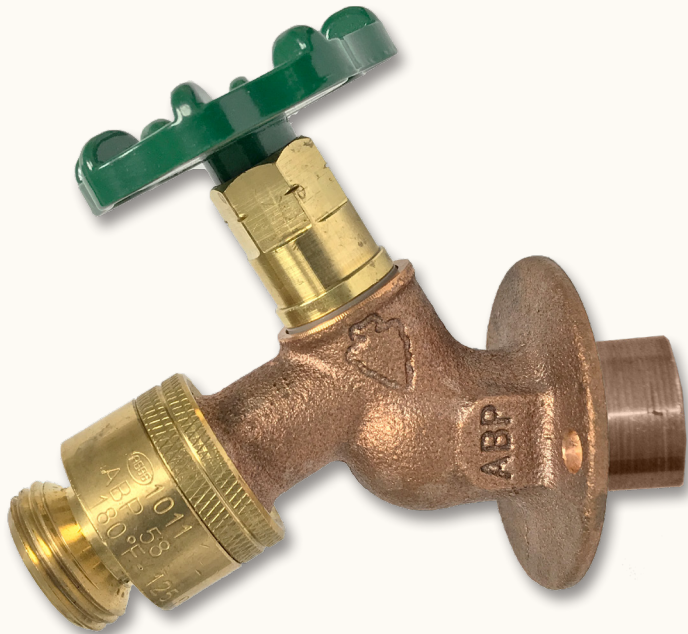

Lead-Free Commercial Sillcocks

Features & Benefits

- Heavy-duty lead-free brass construction. NSF/ANSI 372 certified Lead Free by IAPMO.
- Utilizes Arrowhead's exclusive no-leak one-piece bonnet with EPDM O-ring seal or maintenance-free, easy operation with years of service.
- Integrated brass flange with enclosed screw holes to securely fasten the sillcock to the wall or wall box.
- Includes ASSE 1011 anti-siphon vacuum breaker, tamper-resistant lock-shield bonnet with green wheel handle.
- For loose key operation to prevent unwanted water use, simply remove the green handle and use the included removable loose key to operate.
- Available in 1/2" (**25SWLF**) and 3/4" (**35SWLF**) copper sweat, and in rough brass, nickel-plated (**P**) or polished chrome (**C**) finishes.
- Maximum pressure: 125 PSI. Max temperature: 140° F
- Flow rate: 5-6 GPM at 50 PSI.
- 3-year limited warranty.
- ASSE 1011 certified.





Lead Free Commercial Sillcocks
25SWLF - 35SWLF Series

Base Model & Options

25SWLF	25SWPLF	25SWCLF
# 25SWLF 1/2" copper sweat x 3/4" Male Hose Thread, Rough Brass	# 25SWPLF 1/2" copper sweat x 3/4" Male Hose Thread, Nickel-plated	# 25SWCLF 1/2" copper sweat x 3/4" Male Hose Thread, Polished Chrome
35SWLF	35SWPLF	35SWCLF
# 35SWLF 3/4" copper sweat x 3/4" Male Hose Thread, Rough Brass	# 35SWPLF 3/4" copper sweat x 3/4" Male Hose Thread, Nickel-plated	# 35SWCLF 3/4" copper sweat x 3/4" Male Hose Thread, Polished Chrome

Component	Material
Valve Body	Lead Free Brass*
Stem	Lead Free Brass*
Lock-Shield Bonnet	Lead Free Brass*
O-ring	EPDM
Seat Washer	SBR
Seat Screw	Stainless Steel
Bonnet Washer	Nylon
Handle & Key	Aluminum
Handle Screw	Stainless Steel
Vacuum Breaker	Lead Free Brass*, POM, NBR & Stainless Steel

Now available, Commercial Sillcock Wall Box: # ACSB. See below for more details.



Repair & Replacement Parts

ID	Part #	Description
1	PK1250	Replacement Green Wheel Handle & Stainless Steel Self-Tapping Screw
2	PK1150	Replacement Lock-Shield Stem Assembly & Loose Key
2	PK1155	Replacement Lock-Shield Stem Assembly & Loose Key - Chrome Plated
3	PK1000	Stem Rebuild Kit: Seat washer, seat washer screw, nylon bonnet washer & handle screw
4	PK1300	Replacement Loose Key
5	58ABP	Replacement Vacuum Breaker
5	58ABPCHR	Replacement Vacuum Breaker - Chrome Plated
6	ACSB	Commercial Sillcock Wall Box, Nickel Plated Brass

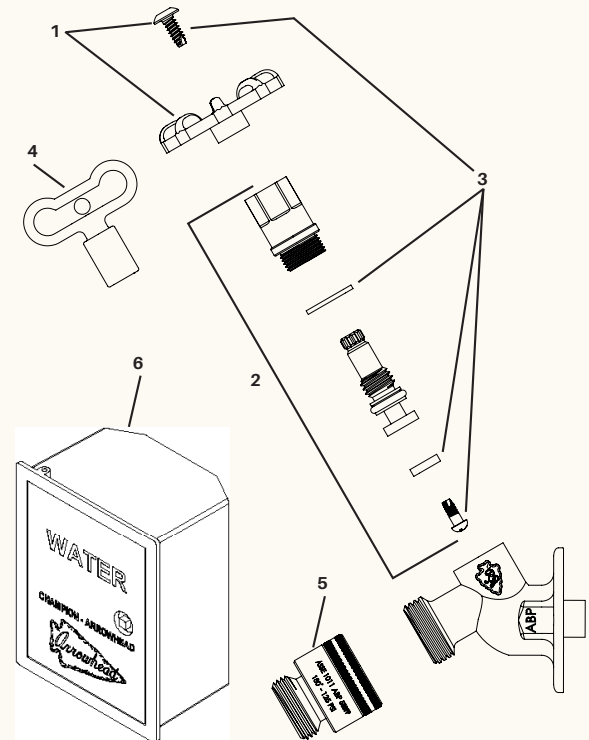

WARNING: This product can expose you to chemicals including lead, which is known to the State of California to cause cancer and reproductive harm. For more information, go to www.P65Warnings.ca.gov